

# TS-L SERIES

## Lobe Pumps



Max. Capacity: 58 m<sup>3</sup>/h



Max. Differential Pressure: 20 bar



Max. Viscosity: 250.000 cSt



Temperature Range: -15 °C to +150 °C

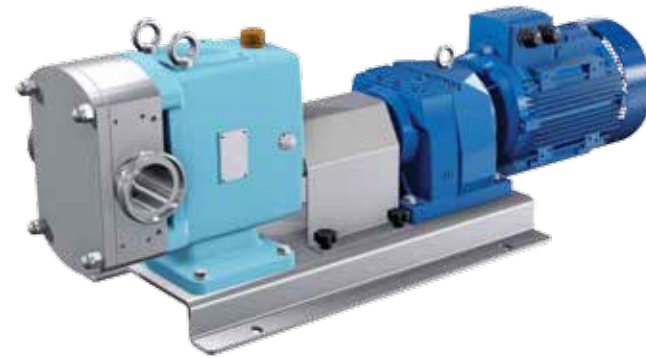

### FEATURES AND ADVANTAGES:

- Three gearbox options with seven types of pump models.
- All wetted parts are manufactured from Stainless Steel 316.
- Heating / Cooling jackets available on all sizes.
- DIN11851 connection supplied as standard, machined from a solid block Stainless Steel 316, meaning no welds on the pump head.
- Single seal which can be modified to a double type (flushing) with a minimum of additional part.
- Horizontal or vertical ports on all pump sizes.
- Bi-directional operation.
- Inlet / outlet connection ports can be offered with DIN 11851, tri clamp, RJT or flange.
- Lobe type can be offered with single wing, bi-wing, tri-lobe and multi lobe according to application and all are universal to suit any pump head.
- Clearances can be machined to suit any viscosity.
- Inlet port can be rectangular for high viscosity applications.

Tapflo's TS-L Lobe Pump Series is specifically designed to make dismantling simple and efficient; whether it's for inspection, cleaning, or maintenance, taking care of your Lobe Pump has never been easier.

The forward-seal position places the seals in direct contact with CIP fluids. Superior seal cleanliness maximises seal life and minimizes seal flaking that could cause product contaminations. The seals are located directly behind the rotors, which eliminates areas of product entrapment for superior hygienic performance.

The unique front-loading seal design offers faster maintenance, easier cleaning, and less downtime. The only dismantling required is the front cover, the rotors, and the seals, all of which can be removed without taking the pump away from installation.

The TS-L series suits all hygienic pumping applications in the food, dairy, beverage, pharmaceutical and other sectors where high standards of hygiene are required.



Flange Connection



Casing & Cover Jacketed



The lobe types can be applicable for same casing.

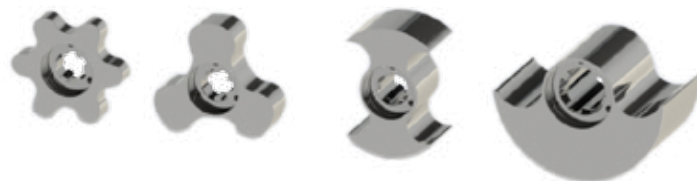

The lobe types according to application: Single Wing, Bi-Wing, Tri-Lobe, Multi-Lobe

TS-L Series	Model	Capacity			Standard Connection Diameter		Max. Pressure		Max. Speed
		Liter 1 rev.	Int Galon 100 rev.	Us Galon 100 rev.	mm	Inches	PSI	Bar	rpm
1	TS-L 125	0.05	1.10	1.32	25	1	300	20	1000
	TS-L 140	0.12	2.64	3.17	40	1.5	175	12	800
	TS-L 150	0.21	4.61	5.54	50	2	115	8	800
2	TS-L 250	0.4	9.01	10.81	50	2	175	12	700
	TS-L 265	0.62	13.63	16.35	65	2.5	115	8	700
3	TS-L 380	1.02	22.42	26.90	80	3	175	12	600
	TS-L 3100	1.44	31.65	37.98	100	4	115	8	600